



19 Palmerston Street

, Bedford, MK41 7SE

£325,000



Floor Plan

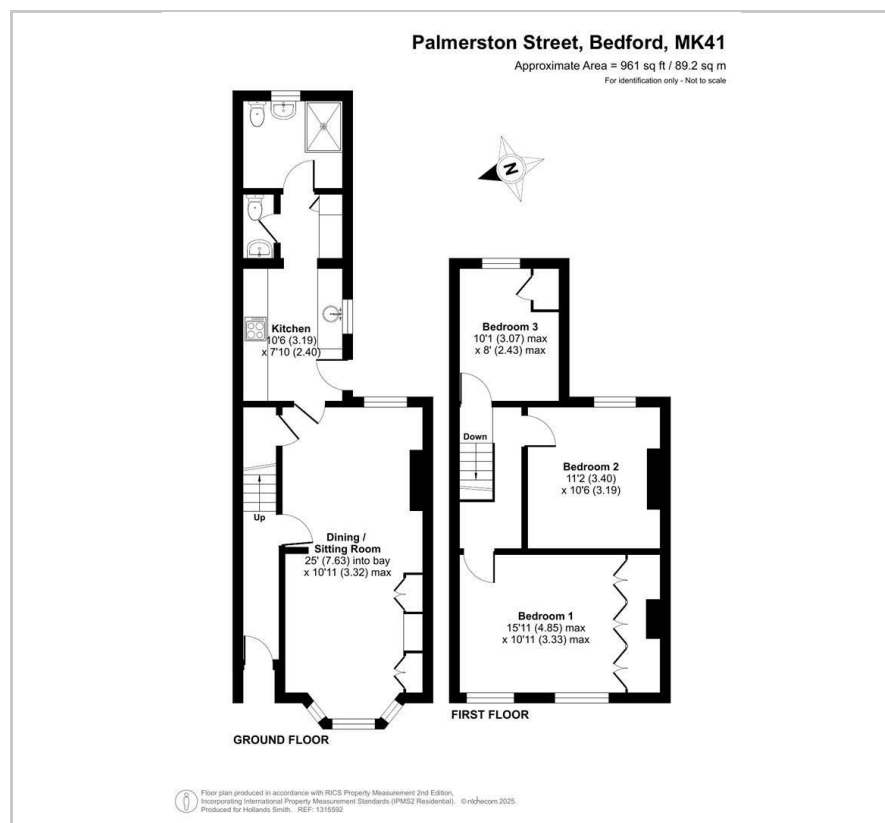

Area Map

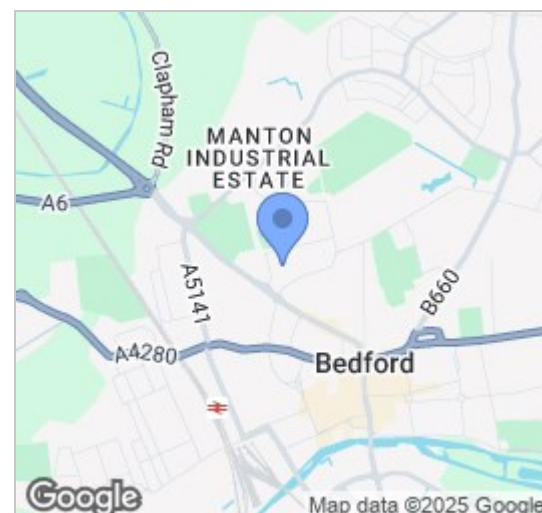

Energy Efficiency Graph

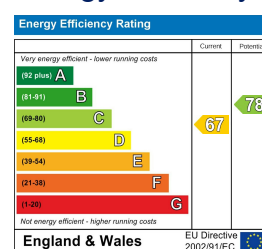

Viewing

Please contact our Bedford Office on 01234 216612 if you wish to arrange a viewing appointment for this property or require further information.

- Larger Than Typical Period ■ Three Bedrooms Terrace
- Combined Sitting/Dining Room ■ Modern Kitchen
- Ground Floor Bathroom and ■ uPVC Double Glazing Second WC
- Gas Radiator Heating ■ Low-Maintenance Garden

This spacious period terrace occupies a popular position with the 'Prime Ministers' area of the town and offers larger than usual accommodation with the first floor extending part way across the side passage. The two reception rooms have been combined to provide one open plan space and there are three bedrooms, two with fitted storage. The recently replaced kitchen has some built-in appliances and there is a handy utility room along with a ground floor shower room and separate second WC, all with modern fittings. Further benefits include period features such as a solid fuel burner in the living room, gas to radiator heating from a combination boiler and uPVC double glazed windows throughout. Outside, there is a low-maintenance courtyard garden and easy access to the side passageway for bikes and bins.

The immediate 'Prime Minister's' area of the town is popular for people of all ages with a choice of amenities including convenience stores, pubs and coffee shops. Bedford Park is just around the corner and offers sports facilities such as tennis and a weekly park run and is home to Robinson Pool and Gym Complex. Bedford town centre is just a short walk away, as is the mainline rail station offering fast links into London St Pancras. EER: D 67



163 Castle Road, MK40 3RT

Tel: 01234 216612

www.hollandsmith.co.uk